

Hilton La Jolla Torrey Pines Capacity Chart & Floor Plans

Room Name	Square Feet	Dimensions	Ceiling height	Classroom	Theater	U-Shape	Hollow Square	Rounds of 10	Reception	Exhibits 8x10
Grande Ballroom	12,035	83'x116'	15'3"	800	1,370	-	-	1050	1,500	64
Ballroom A,B,D or E	2,010	41'8"x48'3"	15'3"	108	192	41	54	140	250	
Ballroom AB,C or DE	4,005	83'x48'3"	15'3"	200	456	74	90	310	500	18
Ballroom ABC or CDE	8,023	83'x96'8"	15'3"	540	924			700	1,000	38
Prefunction Grande Ballroom	4,000			-	-	-	-	-	500	
Scripps Ballroom	3,348	41'x81'8"	14'	180	380	74	84	220	480	13
Scripps Ballroom I or II	1,671	41'x40'9"	14'	90	160	38	46	120	240	
La Jolla Rooms										
Cove, Shore or Canyon	624	24' x 26'	12'	30	60	25	30	40	50	
Executive Board Rooms	450	18' x 25'	9'	Permanent Seating for 12 people						
Hospitality Suites										
3095 A or B (Lobby Level)	100	8'x12'	8'6"		16	9	12	10	10	
3099 A or B (Lobby Level)	100	8'x12'	8'6"		16	9	12	10	10	
3097 (Lobby Level)	528	22'x24'	8'6"	25	45	18	24	40	40	
1031, 1059 and 1102	450	18'x25'	8'6"	18	35	12	16	30	30	
Outdoor Space										
Parterre Garden I	5,472	76'x72'	-	-	-	-	-	300	-	500
Parterre Garden II	3,072	48'x64'	-	-	-	-	-	150	-	200
Parterre Terrace	2,560	-	-	-	-	-	-	-	-	320
Pacific View Terrace	3,600	-	-	-	-	-	-	80	100	-
Poolside	7,000	-	-	-	-	-	-	250	350	-
Fairway Ballroom	6,203	78.5' x 79'	14'	400	700			500	800	27
Fairway I or II or III or IV	1,482	38' x 39'	14'	75	150	35	40	110	150	
1/2 Fairway Ballroom	2,964	39'x72'	14'	160	300	65	75	240	400	
Prefunction Fairway Ballroom	2,460	30'x82'	17'						200	
Outdoor Space										
Fairway Terrace	3,600		-	-		-	-	80	100	-
Fairway Gardens	7,200	60' x 120'	-	-	0	-	-	220	500	-

Floor Plans

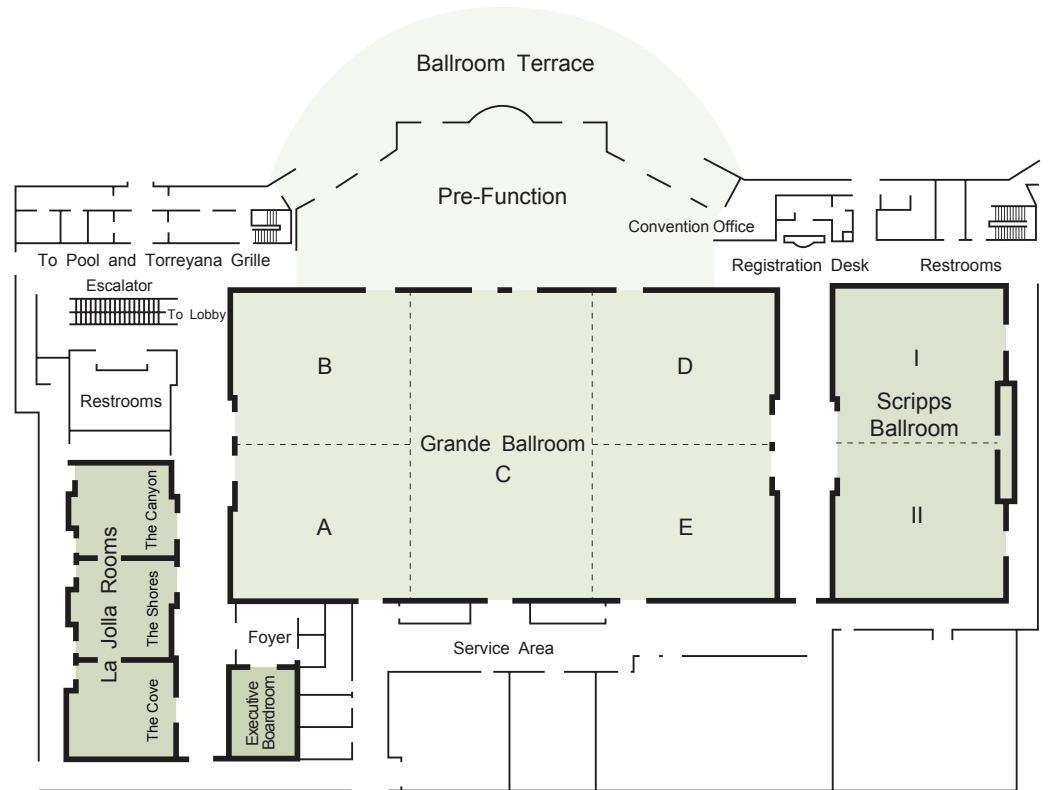
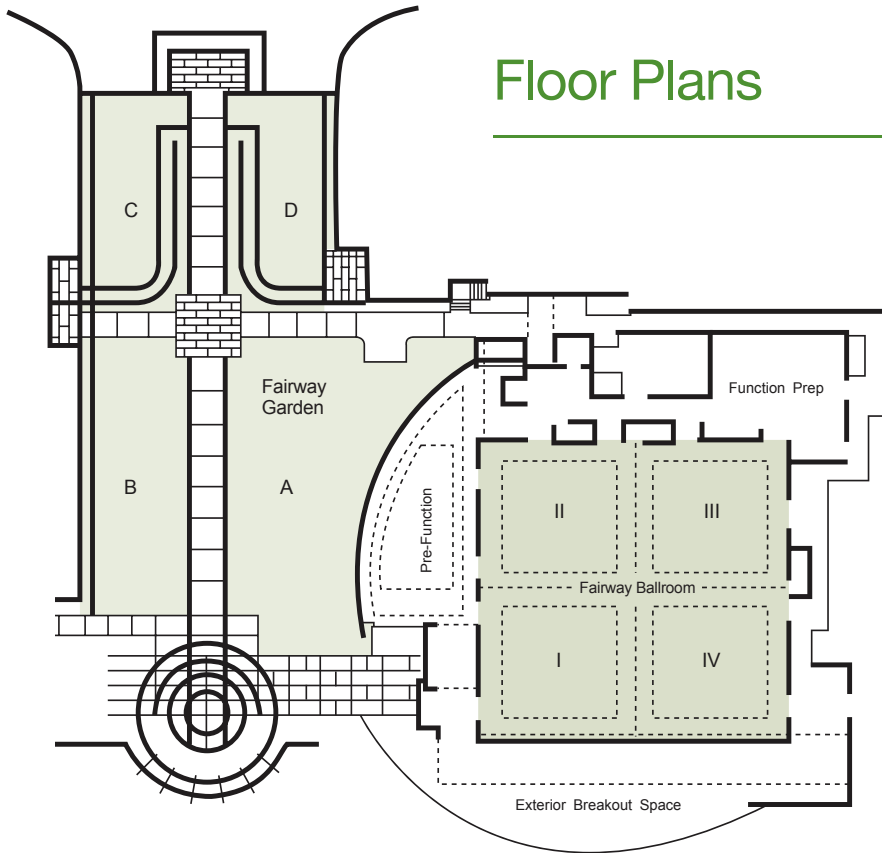

Hotel: 858.558.1500 | Sales: 619.270.2600 | santp-salesadm@hilton.com | Catering: 858.450.4547

10950 North Torrey Pines Road | La Jolla, CA 92037

www.hiltonlajollatorreypines.com

